

BALZAC / AIRDRIE AREA

AIRDRIE

CALGARY

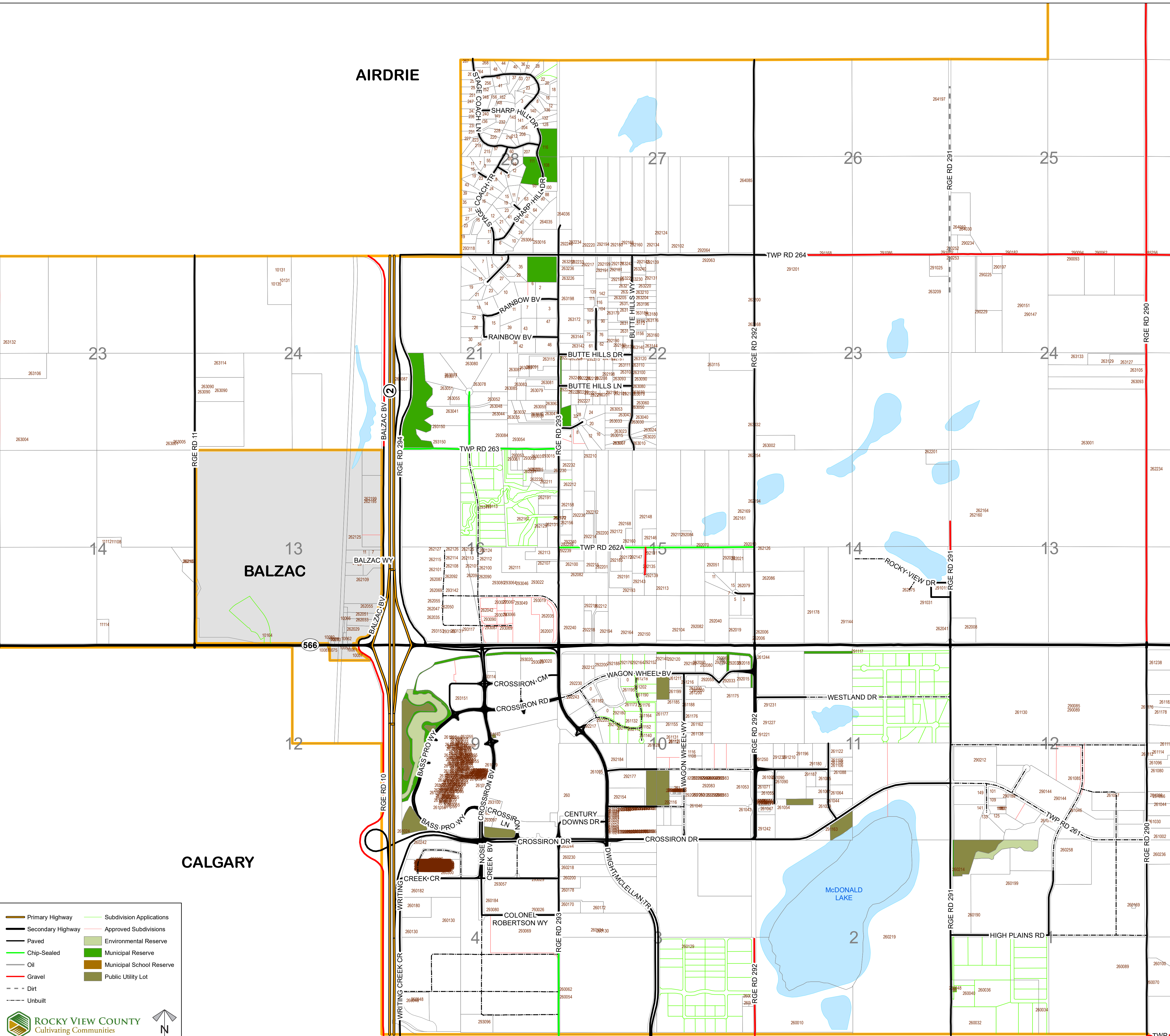
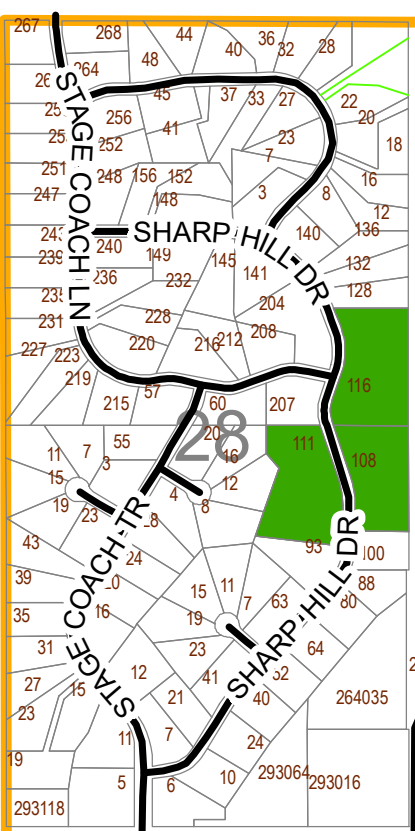

- Primary Highway
- Secondary Highway
- Paved
- Chip-Sealed
- Oil
- Gravel
- - - Dirt
- - - Unbuilt
- Subdivision Applications
- Approved Subdivisions
- Environmental Reserve
- Municipal Reserve
- Municipal School Reserve
- Public Utility Lot

TWP RD 260